

# GN 817.3

## Indexing plungers

- **Material**

Black-oxide steel.

- **Plunger**

Hardened and ground steel.

- **Plastic knob**

Polyamide based (PA) technopolymer, black colour, matte finish, not removable.

- **Standard executions available**

- Execution **B**: without rest position.

- Execution **C**: with rest position.



### Features and applications

Indexing plungers GN 817.3 have been developed to enable precise locating when guide bushes GN 770 are used. For this purpose as a rule, as a plain guide bush (Type A), is used whereby the dimension  $l_3$  of the plunger determines the length of the bush.

The precise location is, therefore, not dependent on the guide pin in the plunger, but on the accuracy of the guide bush (bore tolerance G6) and the plunger (tolerance h7). Both components are hardened and ground. It goes without saying that the bush length also influences the accuracy of the positioning.

Type C with rest position is used in such applications where the plunger must not protrude continually. In that case the knob is retracted and afterwards turned by 90°. A notch is provided for the key to prevent the plunger from turning by error or vibration.

Indexing elements

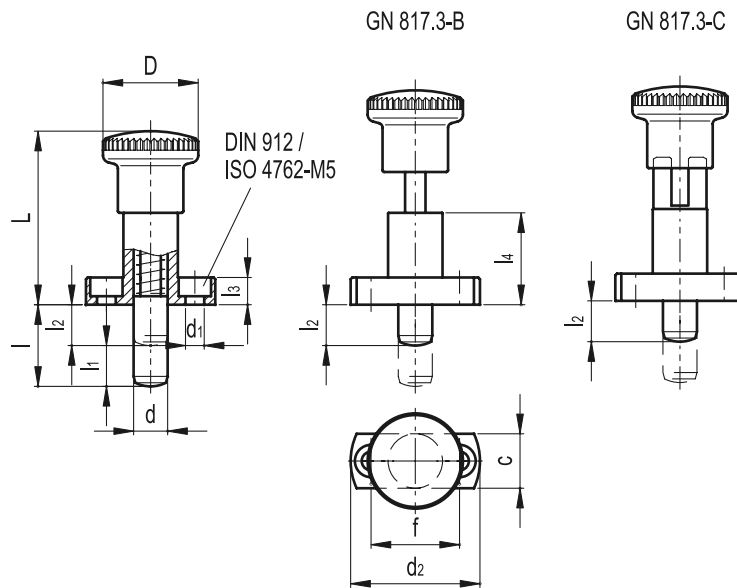

Standard Elements	Main dimensions											Spring pressure		g	
	d h7	l	l1	l2	l3	l4	L	D	d1	d2	f	c	Preload [N~]		Max. load [N~]
GN 817.3-8-20-B	8	20	10	10	8	27	51	28	5.5	38	26	16	8.5	28	78
GN 817.3-8-22-B	8	22	10	12	8	27	51	28	5.5	38	26	16	8.5	28	80
GN 817.3-8-26-B	8	26	10	16	8	27	51	28	5.5	38	26	16	8.5	28	82
GN 817.3-8-30-B	8	30	10	20	8	27	51	28	5.5	38	26	16	8.5	28	84
GN 817.3-10-22-B	10	22	12	10	8	27	51	28	5.5	38	26	16	9.5	28	60
GN 817.3-10-24-B	10	24	12	12	8	27	51	28	5.5	38	26	16	9.5	28	77
GN 817.3-10-28-B	10	28	12	16	8	27	51	28	5.5	38	26	16	9.5	28	79
GN 817.3-10-32-B	10	32	12	20	8	27	51	28	5.5	38	26	16	9.5	28	80
GN 817.3-8-20-C	8	20	10	10	8	27	51	28	5.5	38	26	16	8.5	28	80
GN 817.3-8-22-C	8	22	10	12	8	27	51	28	5.5	38	26	16	8.5	28	82
GN 817.3-8-26-C	8	26	10	16	8	27	51	28	5.5	38	26	16	8.5	28	83
GN 817.3-8-30-C	8	30	10	20	8	27	51	28	5.5	38	26	16	8.5	28	85
GN 817.3-10-22-C	10	22	12	10	8	27	51	28	5.5	38	26	16	9.5	28	80
GN 817.3-10-24-C	10	24	12	12	8	27	51	28	5.5	38	26	16	9.5	28	83
GN 817.3-10-28-C	10	28	12	16	8	27	51	28	5.5	38	26	16	9.5	28	80
GN 817.3-10-32-C	10	32	12	20	8	27	51	28	5.5	38	26	16	9.5	28	100